

NEMA 34 - With 10' Cable - HIGH PERFORMANCE STEPPER MOTOR

QUICKLINK: nema34

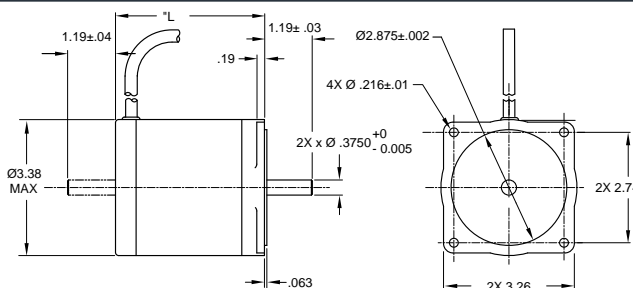

PART #	WIRING DIAG	CONNECTION	MOTOR LENGTH (INCH)	MIN-HOLDING TORQUE (OZ-IN)	# OF LEADS	STEP ANGLE (DEG)	AMPS	OHMS	MH	ROTOR INERTIA (OZ-IN ² / G-CM ²)	MOTOR WEIGHT (LBS.)
5034-367	K	series	2.5	212.0	8	1.8	2.42	1.8	10.0	3.66 / 670	3.40
	J	parallel		212.0			4.84	0.45	2.5		
	H	unipolar		150.0			3.42	0.9	2.5		
5034-368	K	series	3.7	447.0	8	1.8	3.54	1.6	11.6	6.72 / 1230	5.86
	J	parallel		447.0			7.07	0.4	2.9		
	H	unipolar		316.0			5.00	0.8	2.9		
5034-369	K	series	5.1	667.0	8	1.8	4.17	1.44	10.4	10.2/1870	8.02
	J	parallel		667.0			8.34	0.36	2.6		
	H	unipolar		472.0			5.90	0.72	2.6		

Part numbers listed are for single shaft. To order double shaft add "D" to the part number. Example: 5034-367D.

Motors in the table above are optimized for microstepping and use with 160 volt drives. Full CAD drawings and 3D models are available on our website. Use Wiring Diagram H, J or K . - page. 75

NEMA 34 - High Torque - HIGH PERFORMANCE STEPPER MOTOR

QUICKLINK: nemaht34

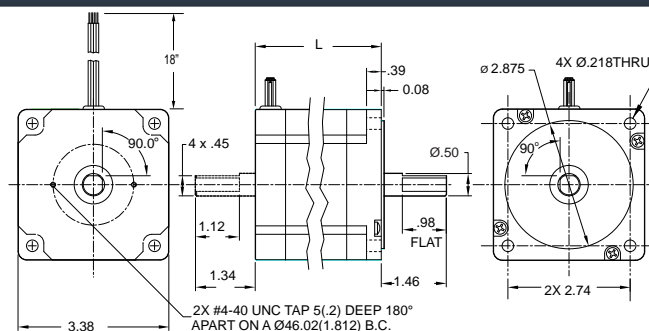

PART #	WIRING DIAG	CONNECTION	MOTOR LENGTH (INCH)	MIN-HOLDING TORQUE (OZ-IN)	# OF LEADS	STEP ANGLE (DEG)	AMPS	OHMS	MH	ROTOR INERTIA (OZ-IN ² / G-CM ²)	MOTOR WEIGHT (LBS.)
HT34-474	G	series	2.60	389	8	1.8	3.15	0.96	7.6	7.65 / 1400	4.00
	F	parallel		389			6.3	0.24	1.9		
	E	unipolar		278			4.5	0.48	1.9		
HT34-476	G	series	3.78	855	8	1.8	3.15	1.32	12.0	14.8 / 2700	6.20
	F	parallel		855			6.3	0.33	3.0		
	E	unipolar		611			4.5	0.66	3.0		
HT34-478	G	series	4.96	1284	8	1.8	2.8	1.94	22.0	21.9 / 4000	8.66
	F	parallel		1284			5.6	0.49	5.5		
	E	unipolar		917			4.0	0.97	5.5		

Part numbers listed are for single shaft. To order double shaft add "D" to the part number. Example: HT34-474D.

All motors in the table above are optimized for microstepping. Use Wiring Diagram E, F or G . - page. 75 . Full CAD drawings and 3D models are available on our website.