

4

3

2

1

MOTOR SPECIFICATIONS:

NUMBER OF PHASES:	2	ROTOR INERTIA (g-cm ² /oz-in ²):	9/0.05 NOM
STEPS PER REVOLUTION:	200	INSULATION CLASS:	B (130°C)
STEP ANGLE (°):	1.8	BEARINGS:	ABEC 3, DOUBLE SHIELDED

CONNECTION	RESISTANCE PER PHASE 5	INDUCTANCE PER PHASE 6	RATED CURRENT	HOLDING TORQUE 1	
	ohm ±10%	mH ±20%	AMP	mNm MIN	oz-in MIN
BI-POLAR	1.4	1.3	1.0	50	7.08

GEARMOTOR SPECIFICATIONS:

TEMP. RISE (°C): 7	80 MAX	TOTAL WEIGHT (±10g/±0.35oz):	150/5.29
OPERATING AMB. TEMP. RANGE (°C):	-10 to +50	RELATIVE HUMIDITY RANGE (%):	85 NON-CONDENSING
STORAGE TEMP. RANGE (°C):	0 to +40		

GEARHEAD SPECIFICATIONS:

RATIO:	4:1	EFFICIENCY (%):	90
MAX TORQUE CONTINUOUS (Nm/oz-in):	0.5/70.8	BACKLASH (°):	≤1.2
MAX TORQUE (Nm/oz-in):	0.8/113.3	MAX RADIAL LOAD (N/lbf):	≤20/4.49
MAX INPUT SPEED (RPM):	6000	MAX AXIAL LOAD (N/lbf):	≤20/4.49

NOTES, UNLESS OTHER WISE SPECIFIED:

- 1 MEASUREMENTS MADE AT RATED CURRENT IN EACH PHASE.
2. HIPOT 500 VAC, 60Hz FOR ONE MINUTE.
- 3 LEADS: 4, 26 AWG, 7 STRAND MIN. UL AND CSA APPROVED. UL 1007.
4. INSULATION RESISTANCE: 100 MEGOHMS MIN AT 500 VDC.
- 5 AS MEASURED ACROSS EACH PHASE.
- 6 AS MEASURED ACROSS EACH PHASE USING AN A.C. INDUCTANCE BRIDGE AT 1KHz.
- 7 AS MEASURED BY THE CHANGE IN RESISTANCE METHOD, WITH RATED CURRENT APPLIED TO 2 PHASES; WITH MOTOR AT REST.
8. THIS MOTOR IS MANUFACTURED IN COMPLIANCE WITH CURRENT EU RoHS DIRECTIVE.
- 9 MOTOR LABEL TO INCLUDE AMP LOGO, AMP WEBSITE ADDRESS, "RoHS" COMPLIANCE LOGO, AMP P/N, 'MADE IN (COUNTRY)', AND DATE CODE.
- 10 ADD "D" TO PART NUMBER IF DOUBLE SHAFT IS REQUIRED.
DOUBLE SHAFT REQUIRES ADDED HOLES FOR ENCODER OPTION.

REVISIONS

ECO #	REV.	DESCRIPTION	DATE	APPROVED
7935	A	INITIAL RELEASE	7/2/18	J. KORDIK
8429	B	TYP0 CORRECTION	3/3/20	J. KORDIK
8758	C	REDRAWN IN SOLIDWORKS	4/18/22	L. LIU

Sold & Serviced By:



Canadian and International Sales

ELECTROMATE

877-737-8698

sales@electromate.com

www.electromate.com

U.S. Sales

SERVO2GO.com

877-378-0240

sales@servo2go.com

www.servo2go.com

WIRING DIAGRAM

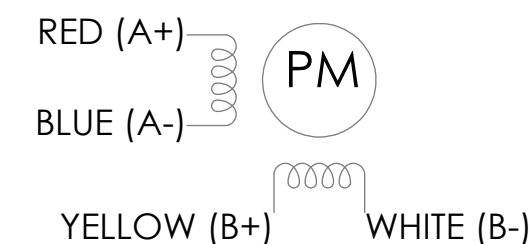
DRIVE SEQUENCE MODEL
BI-POLAR FULL STEP

STEP	A+	A-	B+	B-	ROTATION
1	+	-	+	-	CCW ↑
2	-	+	+	-	
3	-	+	-	+	
4	+	-	-	+	
1	+	-	+	-	

↓ CW

CW (CLOCKWISE) AND CCW (COUNTER-CLOCKWISE) ROTATION
WHEN SEEN FROM THE MOUNTING FACE END OF THE MOTOR

PROPRIETARY AND CONFIDENTIAL

THE INFORMATION CONTAINED IN THIS DRAWING IS THE SOLE PROPERTY OF APPLIED MOTION PRODUCTS. ANY REPRODUCTION IN PART OR AS A WHOLE WITHOUT THE WRITTEN PERMISSION OF APPLIED MOTION PRODUCTS IS PROHIBITED.

THIRD ANGLE PROJECTION		NAME	DATE	TITLE:
UNLESS OTHERWISE SPECIFIED: DIMENSIONS ARE IN MILLIMETERS		DRAWN	4/18/22	
TOLERANCES:		PRE.CHECK		
- ANGULAR: ± 0.5		PRE.APPROVAL		SIZE DWG. NO. REV
- ONE DECIMAL PLACE: ± 0.25		FIN.CHECK	4/18/22	
- TWO DECIMAL PLACES: ± 0.13		SAP: 4611110060153		SCALE: 2:1
MATERIAL		ALT DWG. NO.:		SHEET 1 OF 2
FINISH		ALT SAP:		
DO NOT SCALE DRAWING				

4

3

2

1

4

3

2

1

B

B

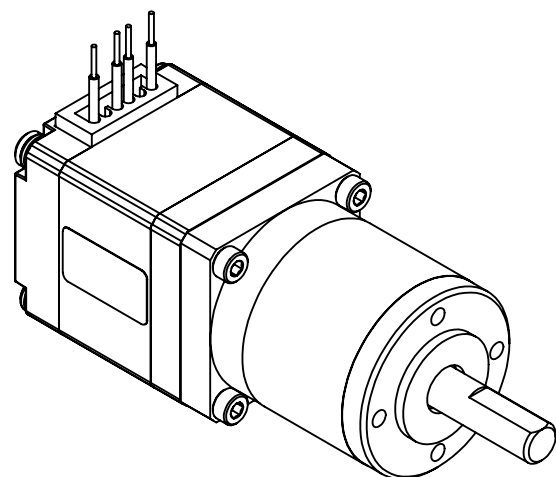
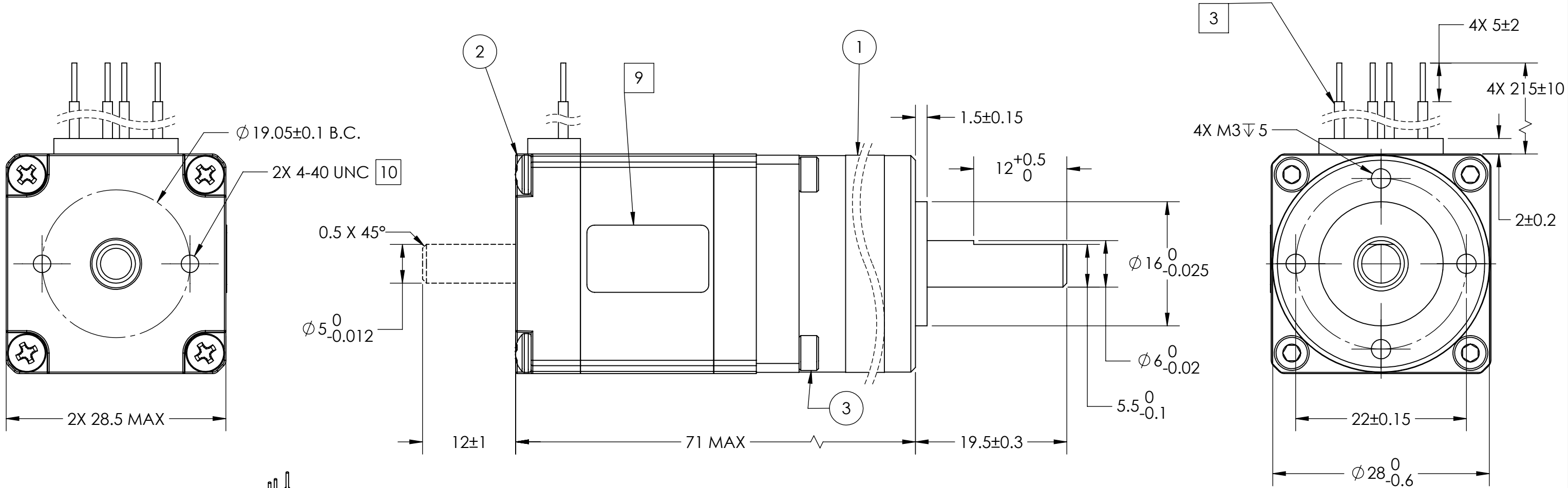

A

A

ITEM NO.	SAP PART NUMBER	PART NUMBER	DESCRIPTION	QTY.
1	4332401001497	28PH004.00-L1	PH GEARHEAD	1
2	4611110012628	HT11-020 10	STEP MOTOR	1
3	4294404001453	91292A012 OR EQUIVALENT	M2.5X8MM STAINLESS STEEL SOCKET HEAD SCREW	4

GEARHEAD MATERIALS:	
GEARTRAIN:	Y100 (1144) STEEL
HOUSING:	304 STAINLESS STEEL
INPUT/OUTPUT FLANGE:	LY12 ALUMINUM
OUTPUT SHAFT:	40Cr STEEL
PINION:	Y100 (1144) STEEL

Applied Motion Products
A MOONS' COMPANY
 PROPRIETARY AND CONFIDENTIAL
 THE INFORMATION CONTAINED IN THIS DRAWING IS THE SOLE PROPERTY OF APPLIED MOTION PRODUCTS. ANY REPRODUCTION IN PART OR AS A WHOLE WITHOUT THE WRITTEN PERMISSION OF APPLIED MOTION PRODUCTS IS PROHIBITED.

THIRD ANGLE PROJECTION	NAME	DATE
UNLESS OTHERWISE SPECIFIED: DIMENSIONS ARE IN MILLIMETERS	DRAWN	Y. LAPNET
TOLERANCES:	PRE.CHECK	4/18/22
- ANGULAR: ± 0.5	PRE.APPROVAL	
- ONE DECIMAL PLACE: ± 0.25	FIN.CHECK	C. BREUNINGER
- TWO DECIMAL PLACES: ± 0.13	SAP: 4611110060153	4/18/22
MATERIAL	ALT DWG. NO.:	
FINISH	ALT SAP:	
DO NOT SCALE DRAWING		

TITLE:		
STEPPER MOTOR W/ GEARHEAD		
SIZE	DWG. NO.	REV
B	HT11-020-G004	C
SCALE: 2:1		SHEET 2 OF 2

4

3

2

1