

Double C-Face Power-Off Brakes – MPC

Double C-Face Power-Off Brakes for Nema 17, 23, 34 and 42 Frames

MPC – Brake Only Module (Power-Off) with Output Shaft C-Face

The MPC is a power-off brake module with an output shaft. The unit mounts on a C-Face motor, and the output can be coupled to a C-Face gear reducer. Ideal for creating brake/motor packages on smaller servo and stepper frame motors.

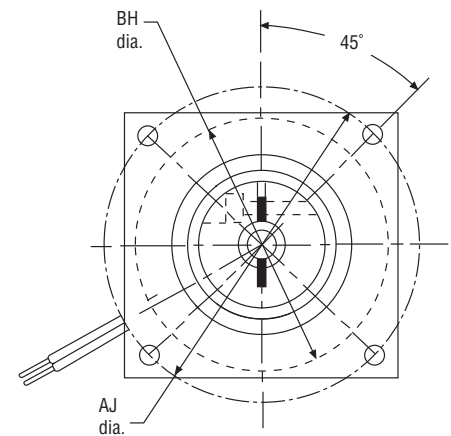
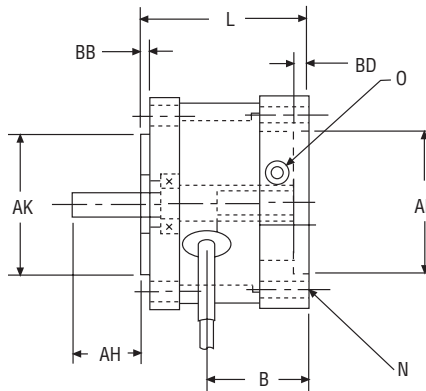
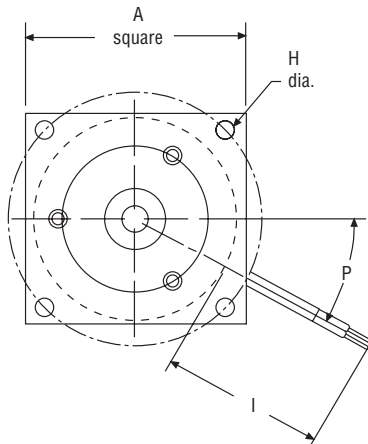
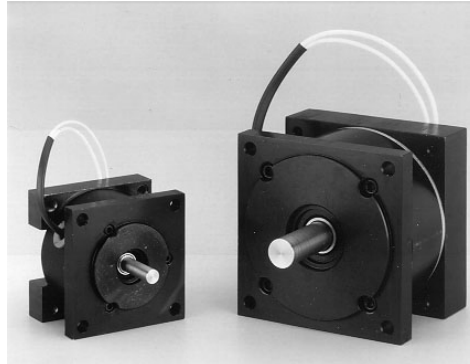

Dimensions

| MODEL NO. | FRAME SIZE | SHAFT & HUB DIA. | A | AH ¹ | AJ | AK | B | BB | BD | BH | H | N | I | L | O*** | P |
|-----------|------------|------------------|------|-----------------|-------|-------|------|------|------|-------|--------------|---------------|-------|-------|--------|----|
| MPC17 | 17 | 3/16 | 1.65 | .71 | 1.725 | .866 | .82 | .080 | .100 | 1.50 | (4) #4-40-2B | (4) .125 | 11.50 | 1.57 | #4-40 | 60 |
| MPC23 | 23 | 1/4* | 2.25 | .70 | 2.625 | 1.500 | 1.18 | .10 | .145 | 2.13 | (4) .205 | (4) #10-24-2B | 16.75 | 1.876 | #6-32 | 30 |
| MPC34 | 34 | 1/2* | 3.25 | 1.16 | 3.875 | 2.875 | 1.58 | .10 | .145 | 2.878 | (4) .222 | (4) #10-24-2B | 18.00 | 2.578 | 1/4-28 | 15 |
| MPC42 | 42 | 5/8** | 4.25 | 1.23 | 4.950 | 2.189 | 2.27 | .10 | .125 | 3.50 | (4) .320 | (4) 3/8-18-2B | 18.00 | 4.056 | 1/4-28 | 90 |

*23 and 34 frame also available in 3/8" bore.

**42 frame also available with 3/8" and 1/2" hub and shaft.

***Socket head cap screw for clamp collar.

¹ Alternate shaft lengths available – consult factory.

Mechanical

| MODEL NO. | STATIC TORQUE LB.-IN. ¹ | INERTIA LB.-IN. ² | WGT. OZ. |
|-----------|------------------------------------|------------------------------|----------|
| MPC17 | 1 | .0024 | 7 |
| MPC23 | 3 | .0087 | 17 |
| MPC34 | 15 | .1120 | 46 |
| MPC42 | 50 | .2060 | 96 |

¹Also available in higher torque sizes – consult Inertia Dynamics for more information.

Electrical

| MODEL NO. | 90 VDC | | 24 VDC | | 12 VDC | | 120 VAC |
|-----------|--------|------|--------|------|--------|------|---------|
| | AMPS | OHMS | AMPS | OHMS | AMPS | OHMS | AMPS |
| MPC17 | .051 | 1880 | .220 | 117 | .430 | 30 | .044 |
| MPC23 | .041 | 2177 | .182 | 132 | .353 | 34 | .048 |
| MPC34 | .098 | 922 | .369 | 65.1 | .719 | 16.7 | .077 |
| MPC42 | .194 | 465 | .717 | 35.5 | .154 | 7.8 | .140 |

Ordering Information

MPC PART NUMBERING SYSTEM

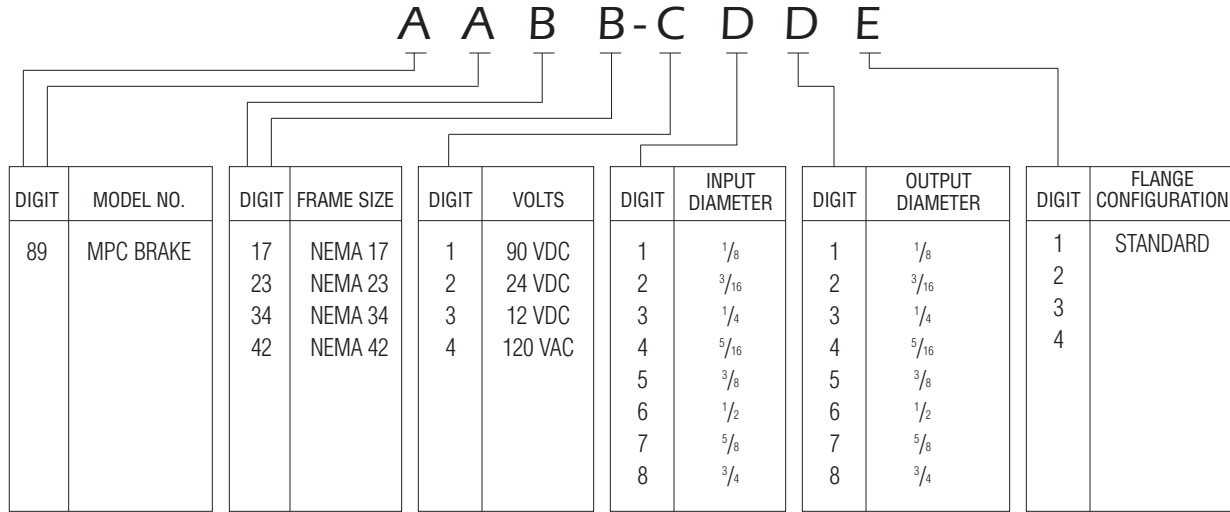

How To Order

- A. Select the model number from the product guide.
- B. Select the frame size.
- C. Select the voltage.
- D. Select the input and output diameter.
- E. Reserved for special torque – consult factory.

Example

Model MPC34, 34 frame size, 24 VDC
 1/2" diameter input and output shaft, standard enclosure
 Part No. 8934-2661

Underwriters Laboratories Standards



All Inertia Dynamics standard clutches, brakes, and spring applied brakes are recognized by Underwriters Laboratories to both U.S. and Canadian safety requirements. Products built to meet their construction requirements are labeled with the UL symbol as shown at above. The products indicated meet UL Class B requirements.